

D-NAMIC

92 Shore A
+90°C
-40°C

INOX

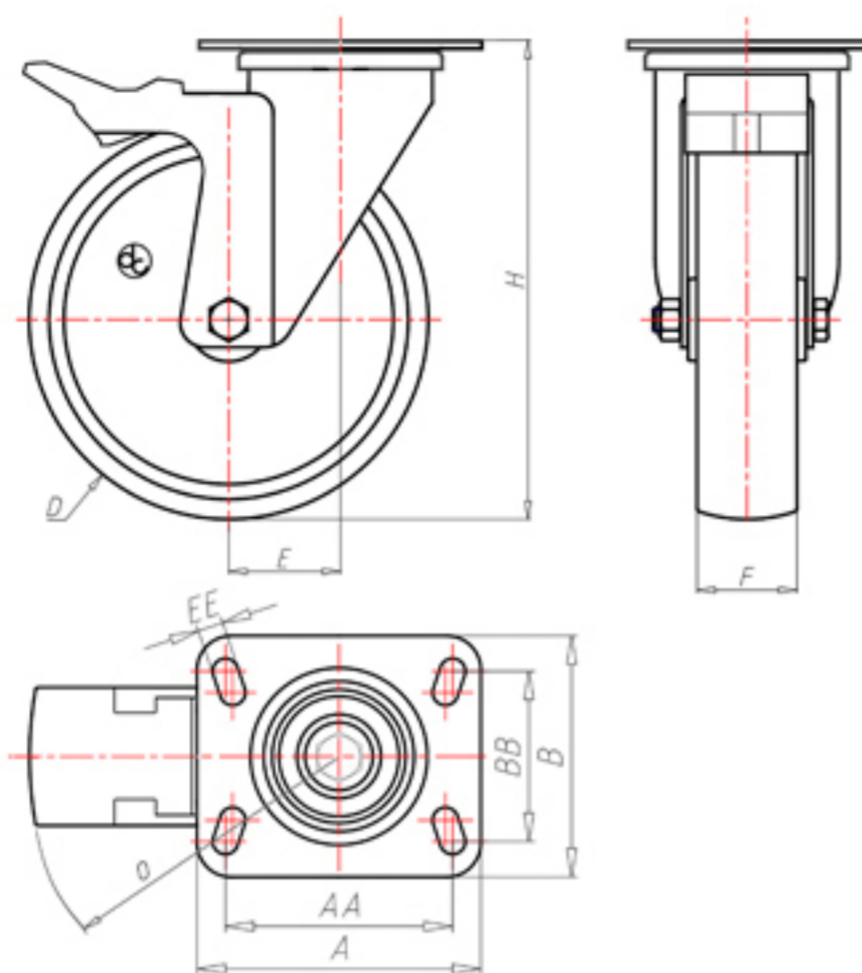

	D	150
	F	40
	H	184
	AxB	135x110
	AAxBB	105x80
	EE	11
	E	52
	O	124
	LC	350



Code for plain bore wheel
XNGX15060PFA



Code for wheel with Inox roller bearing
XNGX15060PRXFA



Code for wheel with double sealed ball bearing
XNGX15060PCFA



Code for wheel with double sealed Inox ball bearing
XNGX15060PCXFA

