

**DITHERM  
STW**

+280°C  
-70°C

**INOX**

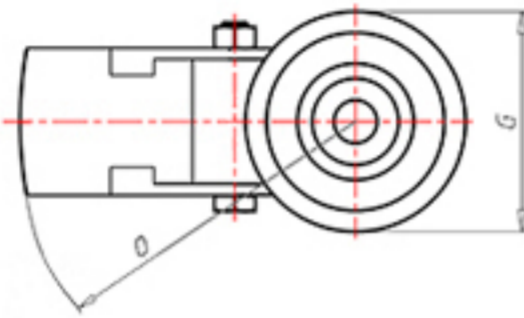
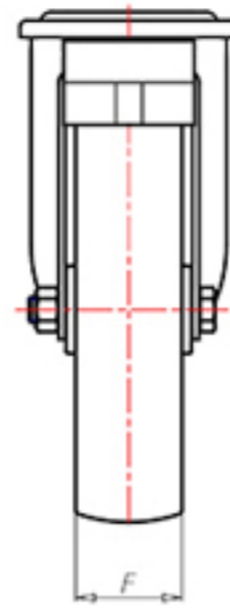
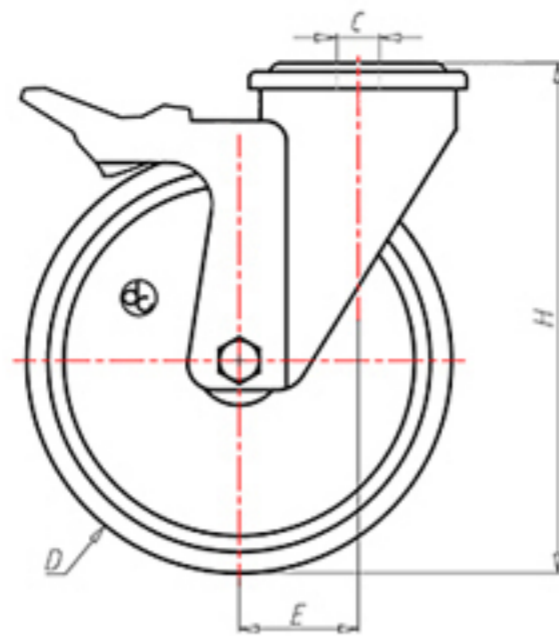

	D	80	
	F	30	
	H	108	
	G	Ø 77	
	C	Ø 12	
	E	40	
	O	124	
	Kg weight	LC	200



Code for plain bore wheel

**SPX80FA**



Code for wheel with coated bush

**SPX80BRFA**



Code for wheel with double BT self-lube bush

**SPX80BTFA**



Code for wheel with double HT ball bearing

**SPX80CFA**

