

D-NAMIC

92 Shore A
+90°C
-40°C

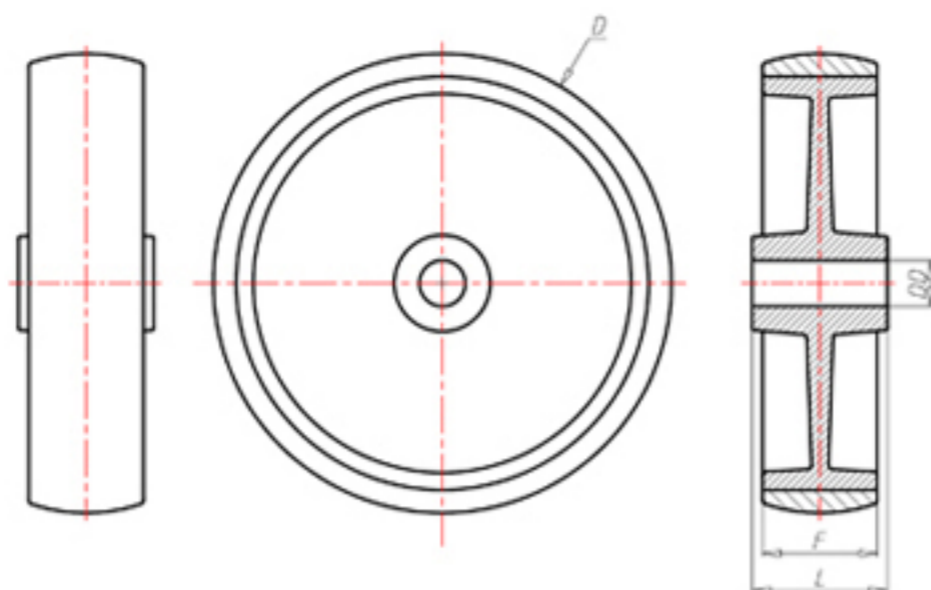

	D	200
	F	40
	L	50
	DD	Ø 20
	LC	700



Code for plain bore wheel

-



Code for wheel with roller bearing

-



Code for wheel with Inox roller bearing

-



Code for wheel with double sealed ball bearing

PXN20050C



Code for wheel with double sealed Inox ball bearing

PXN20050CX

